

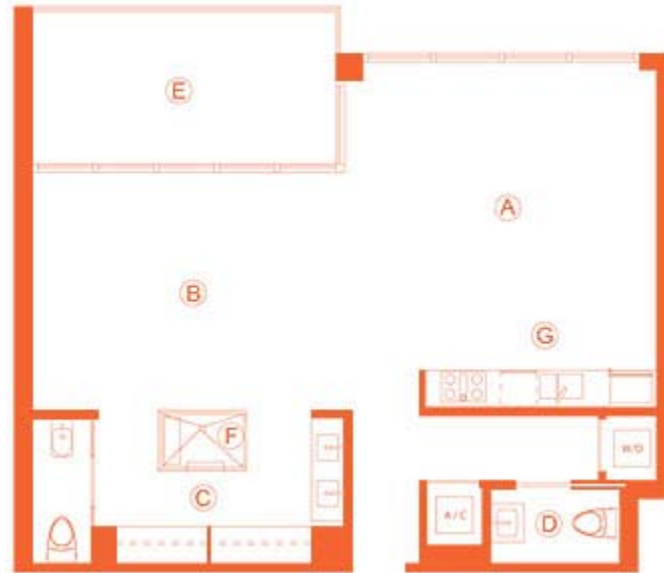

Contact:
Mark Zilbert
 Web: www.zilbert.com
 Tel: (786) 280-0201
 E-Mail: mzilbert@zilbert.com
 Zilbert Realty Group is an independent broker, not affiliated with the developer



UNIT PLANS

UNIT 0003 | 0004 | 0005 | 0006 | **0008** | 1004 | 2103 | 2104 | 2105 | 2106 | 2108 | TOWER SUITE A | B | UPPER PH A | B | LOWER PH A | B

			<h2 style="margin: 0;">UNIT 0008</h2> <p style="margin: 0;">1 Bedroom / 1.5 Baths</p>				
	Interior	L1	898 sf	898 sf		A LIVING ROOM 17'x16'9" B MASTER SUITE 17'x12'11" C BATH SUITE 16'11"x8'3" D POWDER 7'x4' E TERRACE 16'6"x8'6" F SPA	G KITCHEN
	Exterior	L1	143 sf	143 sf			
TOTAL			1041 SF / 98 M2				

We encourage and support affirmative advertising and marketing programs in which there are no barriers to obtaining housing because of race, color, religion, sex, handicap, familial status or national origin.