

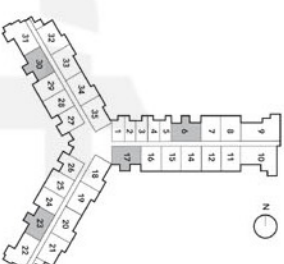

THE NEW  
**HARBOUR HOUSE**  
BAL HARBOUR

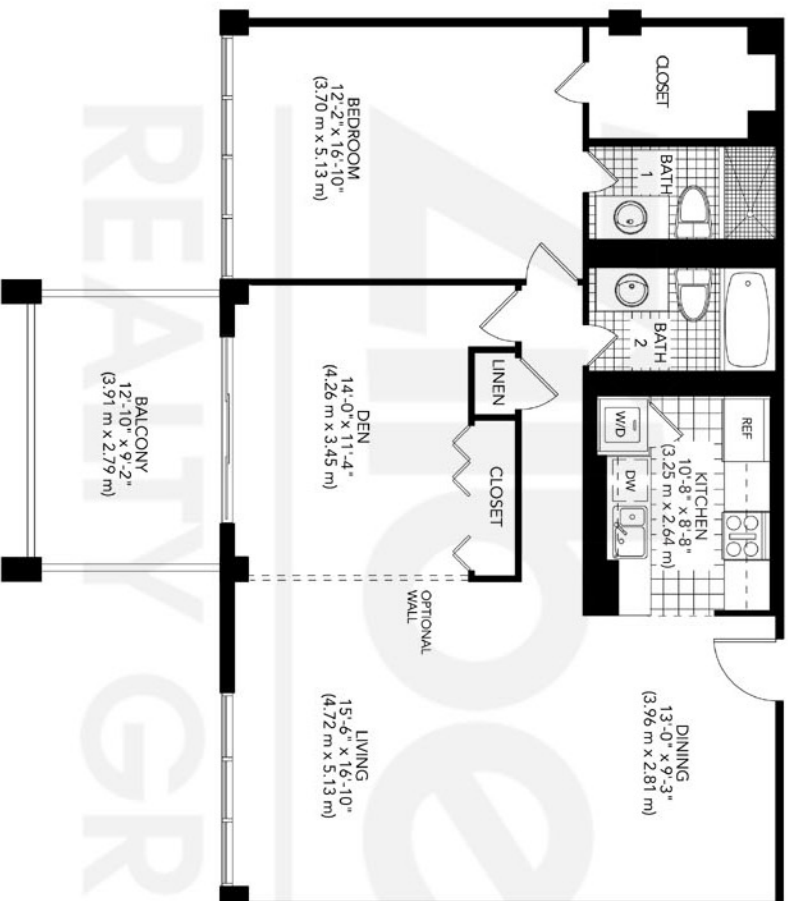

**KEY PLAN**  
Lines 17 & 30  
6 & 23 (Rev)



Contact:  
**Mark Zilbert**  
Web: [www.zilbert.com](http://www.zilbert.com)  
Tel: (305) 726-0100  
E-Mail: [mzilbert@zilbert.com](mailto:mzilbert@zilbert.com)  
Zilbert Realty Group is an independent broker, not affiliated with the developer.

**B**  
mod

1 bedroom/den (convertible) - 2 bath

unit	1,147 s.f.
balcony	122 s.f.
<b>total</b>	<b>1,269 s.f.</b>